

37

**IMPORTANT**

COLD FILL SPECIFICATIONS  
FLUID LEVEL SHOULD BE TO  
THE TOP OF THE BAFFLE  
MARKED "COLD" INSIDE  
THE TANK.

REFER TO OPERATOR'S  
MANUAL FOR TRANSMISSION  
FLUID REQUIREMENTS.

162580

**RIGHT  
SIDE**

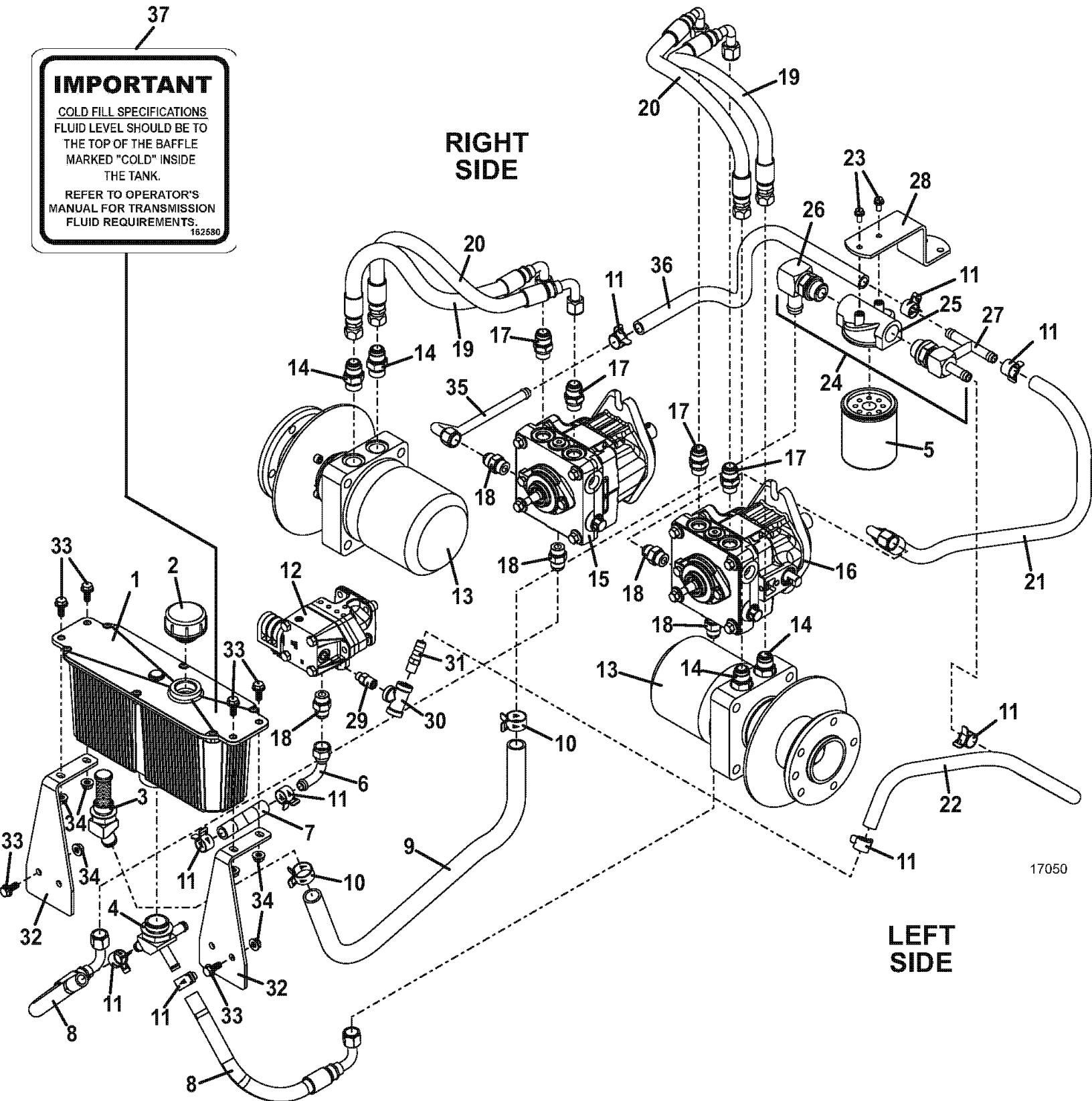

**LEFT  
SIDE**