

INSTALLATION INSTRUCTIONS

(Refer to illustrations)

1. Remove the fenders from the tractor and remove the work light cover from each fender. The existing bolts and nuts will be used to install the LED work lights.
2. Install the LED work lights on the outside of the fenders. Secure each light with the existing bolts and nuts.
3. Insert the 2-way connector from tractor harness into connector from work light assembly (item 2).
4. Remove the light switch hole plug. Locate the unused black wire from the circuit board. Route this wire through the light switch hole and connect it to the bottom post of the light switch (item 1). Locate the push-on terminal with the black wire(s) and install this terminal from tractor harness on the other post of the light switch.
5. Make certain all wires have been routed to prevent chafing and any excess length of wire has been tied to stay clear of all moving parts and pinch points.
6. Install light switch in the control panel and check work light operation.
7. Reinstall the fenders on the tractor.

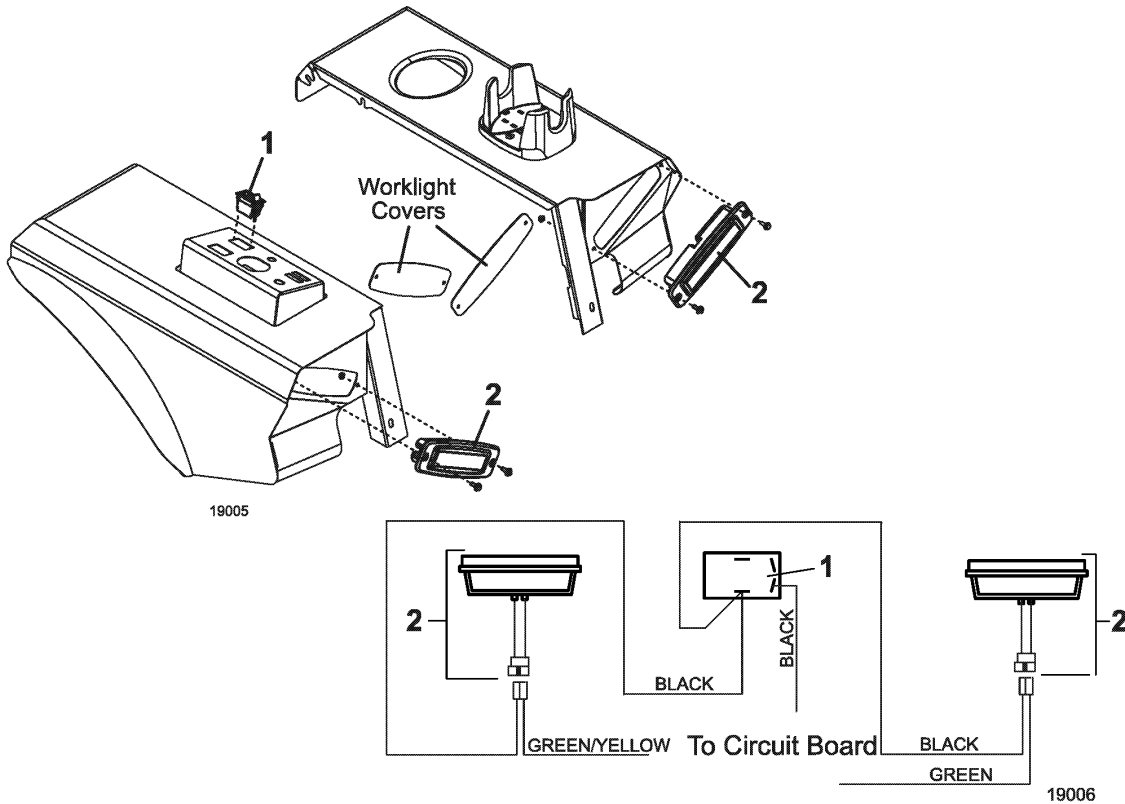

| Item No. | Order No. | Description |
|----------|-----------|---------------------------------|
| 1 | 184179 | Switch - Rocker |
| 2 | 182262 | Work Light - LED Mini Light Bar |