

37

IMPORTANT

COLD FILL SPECIFICATIONS
FLUID LEVEL SHOULD BE TO
THE TOP OF THE BAFFLE
MARKED "COLD" INSIDE
THE TANK.

REFER TO OPERATOR'S
MANUAL FOR TRANSMISSION
FLUID REQUIREMENTS.

162580

**RIGHT
SIDE**

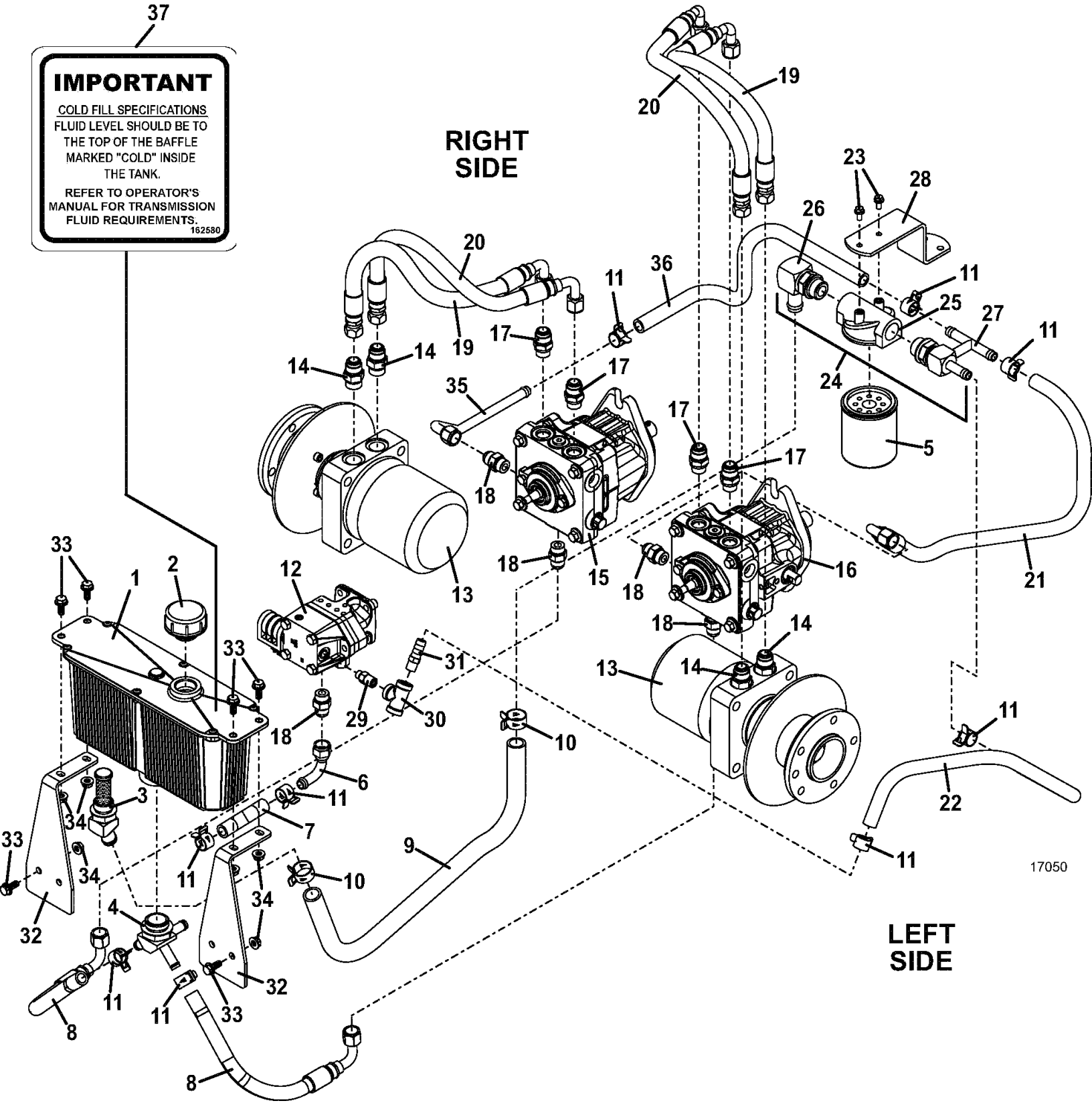

**LEFT
SIDE**