

- Bolt motor mount with motor to the bolt plate (see Fig. 2) with two .375 x 1 carriage bolts (item 2) and .375-16 whiz nuts (item 5). Adjust motor position to allow approximately .125 inch gap between motor gear and spout gear. (See Fig. 3) Tighten .375-16 whiz nuts.

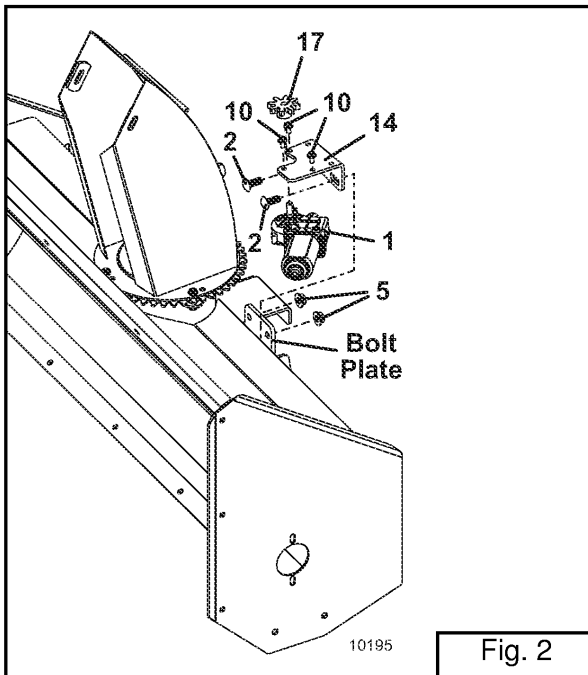

Fig. 2

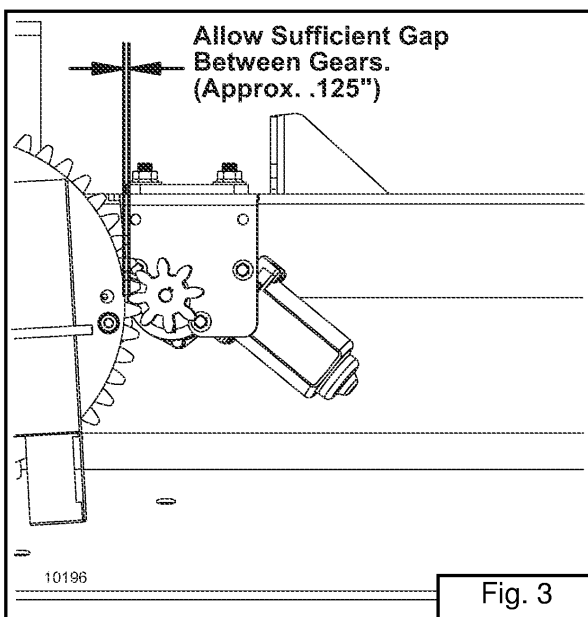

Fig. 3

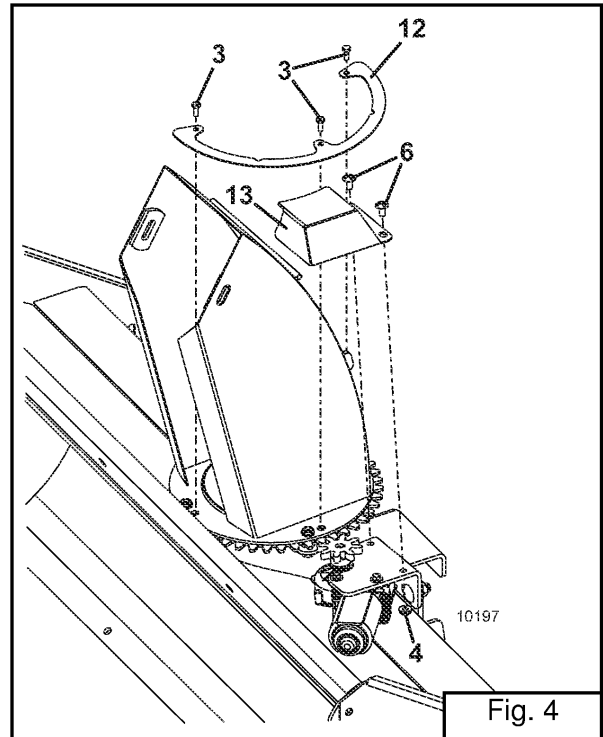

Fig. 4

- Install the spout gear shield (item 12) over the spout gear and secure with three 10-24 machine screws (item 3). (See Fig. 4)
- Install the spout gear motor shield (item 13) over the electric motor (item 1). Secure with two .25-20 x .5 truss bolts and whiz nuts (items 6 & 4).