

- Install new wide seat side assemblies (items 1 & 2), which have been pre-assembled, and reinstall seat reinforcement and back cushion. Secure all with existing bolts removed.
- Reinstall arm rest cushions on wide seat sides and secure with existing bolts and nuts.
- Reinstall seat belts on wide seat sides. Secure with existing bolts, nylon washers and nuts.
- Install seat belt extension (item 11).

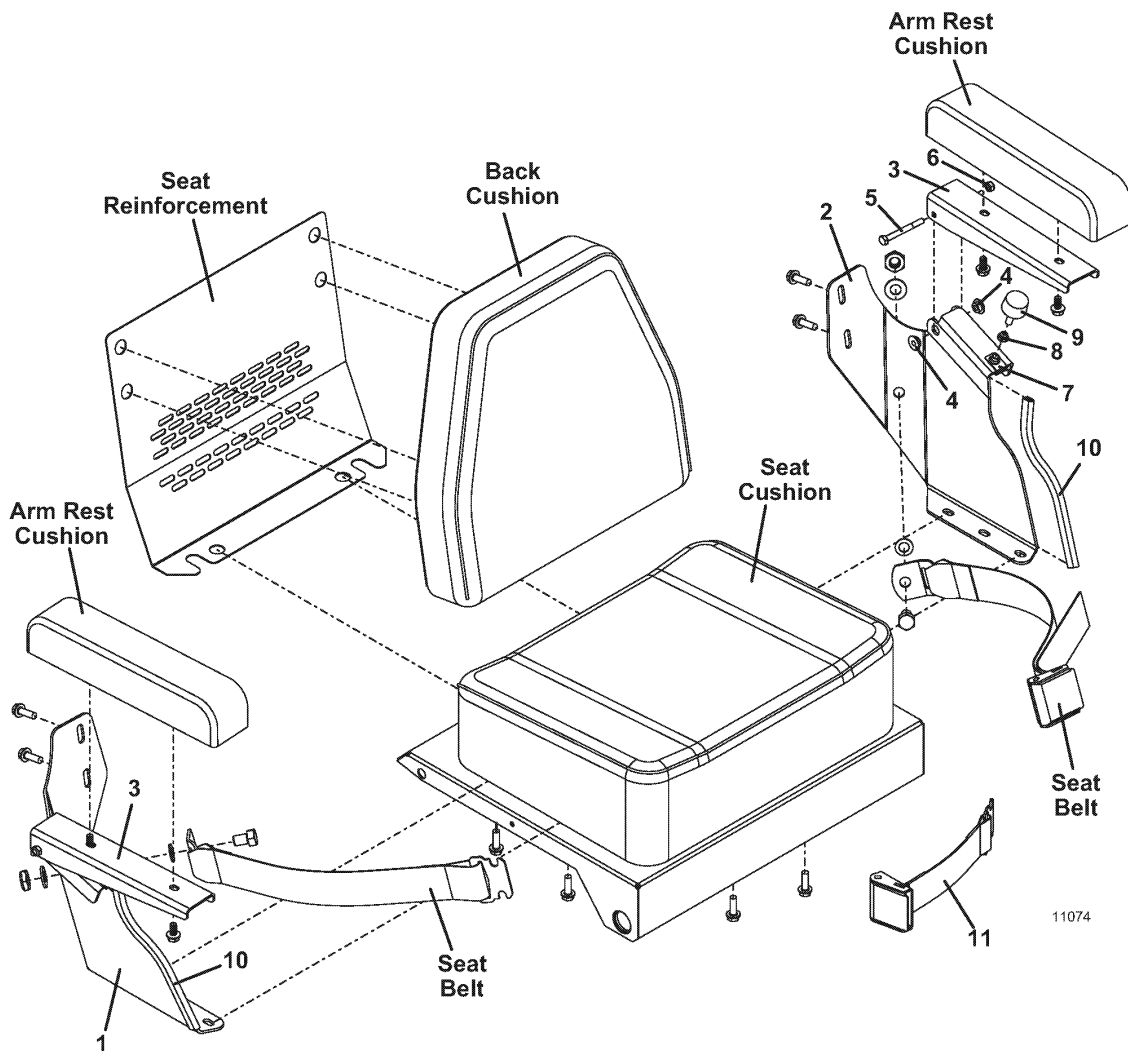

Item No.	Order No.	Description	Item No.	Order No.	Description
1	724940	Seat Side – Fold Arm Rest Rt.	7	830325	Speed Nut .312-18
2	724941	Seat Side – Fold Arm Rest Lt.	8	833542	Cap – Bumper Nut
3	754288	Arm Rest – Folding	9	424056	Bumper
4	422508	Step Bushing	10	822620	Trim – Seat Edge
5	243050	Bolt .25-20 x 2.5	11	324201	Extension – Seat Belt
6	253440	Nut .25-20 Nylon Insert			