

## REMOVAL, INSPECTION AND ASSEMBLY OF BLOCKSPRING, THRUST WASHER AND THRUST BEARING BDP-10A

### Disassembly

- 1) Remove the block spring (29).
- 2) Remove the thrust washer (30).
- 3) Remove the thrust bearing and race (34).

### Inspection

- 1) Inspect and replace the block spring (29) and thrust washer (30) if they are distorted or broken.
- 2) Inspect the running surface of the bearing race for damage, nicks or unusual wear patterns. The running surface may show evidence of minor abrasion. This will be normal wear. Inspect the bearings for free movement. Inspect the bearing cage for distortion or damage. Replace if necessary.

### Assembly

- 1) Install thrust bearing and race assembly (34).

**NOTE: The difference in race thickness: the thin race seats into the swashplate (32). The thicker race will be installed toward the piston noses.**

- 2) Install thrust washer (30).
- 3) Install block spring (29). **Figure 11**

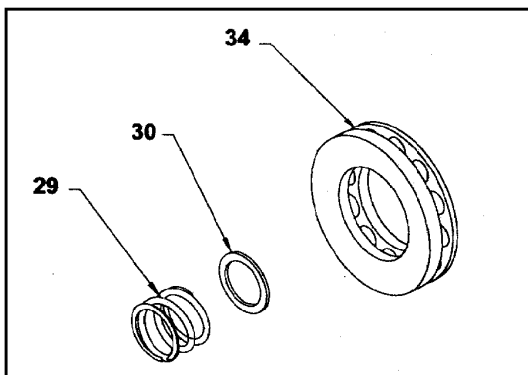

Figure 11

## REMOVAL, INSPECTION AND ASSEMBLY OF THRUST BEARING BDP-21L/ 16A

### Disassembly

- 1) Remove the thrust bearing and race (17).

### Inspection

- 1) Inspect the running surface of the bearing race for damage (17), nicks or unusual wear patterns. The running surface may show evidence of minor abrasion. This will be normal wear. Inspect the bearings for free movement. Inspect the bearing cage for distortion or damage. Replace if necessary.

### Assembly

- 1) Install bearing and race assembly (17).

### **Figure 12**

**NOTE: The difference in race thickness: the thin race seats into the swashplate. The thicker race will be installed toward the piston noses.**

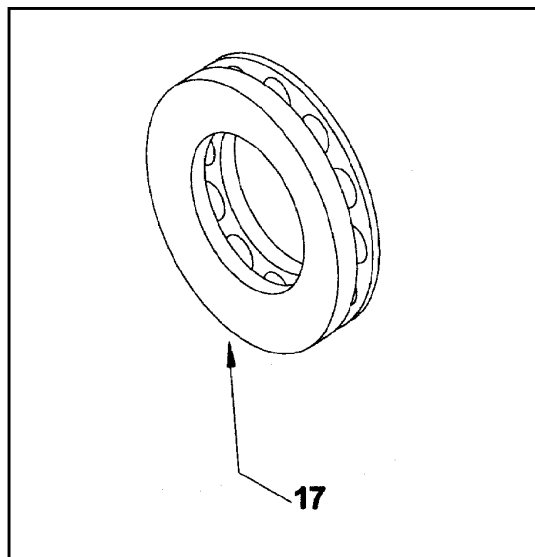

Figure 12